

### MSe(コチャックン) MSe(Collet Chuck) ドリル加工用スプリングコレットチャック Spring Collet Chuck for Drilling

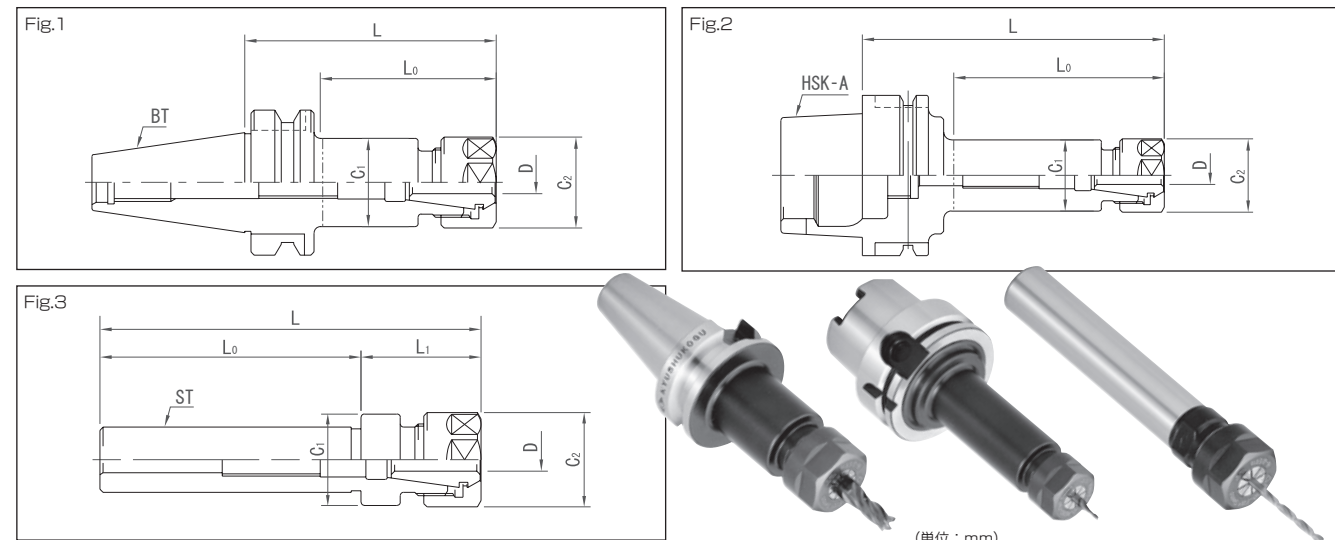

コード Code	図 Fig.	D	L	L <sub>0</sub>	C <sub>1</sub>	C <sub>2</sub>	重量 (kg) Weight	適用ナット Applicable Nut		
									最小 Min.	最大 Max.
BT BT30	1	0.5~7	90	65	18	19	0.6	Hi-Q/ER11;Hi-Q/ERB11		
			60	35			0.7			
			60	35	27	28	0.8	Hi-Q/ER16 Hi-Q/ERB16		
		2.0~13	120	95			1.0			
			60	35			0.8			
			90	65	33	34	1.1	Hi-Q/ER20 Hi-Q/ERB20		
	2.0~16	120	95			1.3				
		60	35			1.0				
		90	65	41	42	1.4	Hi-Q/ER25 Hi-Q/ERB25			
	BT BT40	1	0.5~7	90	60	18	19	1.2	Hi-Q/ER11;Hi-Q/ERB11	
				60	30			1.2		
				90	60	27	28	1.4	Hi-Q/ER16 Hi-Q/ERB16	
2.0~13			120	90			1.6			
			60	30			1.3			
			90	60	33	34	1.5	Hi-Q/ER20 Hi-Q/ERB20		
2.0~16		120	90			1.8				
		60	30			1.6				
		90	60	41	42	2.0	Hi-Q/ER25 Hi-Q/ERB25			
2.0~20		120	90			2.3				
		60	30			1.8				
		90	60	49	50	2.3	Hi-Q/ER32 Hi-Q/ERB32			
	120	90			2.8					
	60	30			1.8					
	90	60	49	50	2.3	Hi-Q/ER32 Hi-Q/ERB32				
BT BT50	1	0.5~7	90	50	18	19	4.1	Hi-Q/ER11;Hi-Q/ERB11		
			135	95			4.6			
			195	155	27	28	5.0	Hi-Q/ER16 Hi-Q/ERB16		
		2.0~13	75	35			4.3			
			135	95	33	34	4.7	Hi-Q/ER20 Hi-Q/ERB20		
			195	155			5.2			
	2.0~16	75	35			4.5				
		135	95	41	42	5.2	Hi-Q/ER25 Hi-Q/ERB25			
		195	155			6.0				
	5.0~20	75	35			4.8				
		135	95	49	50	5.8	Hi-Q/ER32 Hi-Q/ERB32			
		195	155			6.8				
HSK HSK-A63	2	0.5~7	90	58	18	19	0.9	Hi-Q/ER11;Hi-Q/ERB11		
			90	58			1.1			
			120	88	27	28	1.3	Hi-Q/ER16 Hi-Q/ERB16		
		2.0~13	150	118			1.5			
			90	58			1.2			
			120	88	33	34	1.5	Hi-Q/ER20 Hi-Q/ERB20		
	2.0~16	150	118			1.8				
		90	58			1.6				
		120	88	41	42	1.9	Hi-Q/ER25 Hi-Q/ERB25			
	5.0~20	150	118			2.2				
		90	63			2.0				
		120	93	49	50	2.5	Hi-Q/ER32 Hi-Q/ERB32			
150	123				3.0					
	ST	3	0.5~7	130	100	18	19	0.3	Hi-Q/ER11;Hi-Q/ERB11	
				0.5~10	135		27	28	0.4	Hi-Q/ER16;Hi-Q/ERB16
				0.5~10	150		18	19	0.5	Hi-Q/ER11;Hi-Q/ERB11
			2.0~13	155		27	28	0.6	Hi-Q/ER16;Hi-Q/ERB16	
				160		33	34	0.8	Hi-Q/ER20;Hi-Q/ERB20	
180					18	19	1.1	Hi-Q/ER11;Hi-Q/ERB11		
2.0~13		185		27	28	1.1	Hi-Q/ER16;Hi-Q/ERB16			
		190		33	34	1.2	Hi-Q/ER20;Hi-Q/ERB20			

ナット及びコレット、スパナは付属しません。別途お求めください。  
The spring collet, nut, and spanner are not supplied with the product and must be purchased separately.

### MSe(Collet Chuck) MSe(コチャックン) Nut and spanner for MSe MSe用ナット・スパナ KER Collet for MSe MSe用 KERコレット

#### MSe用 ナット・スパナ Nut and spanner for MSe

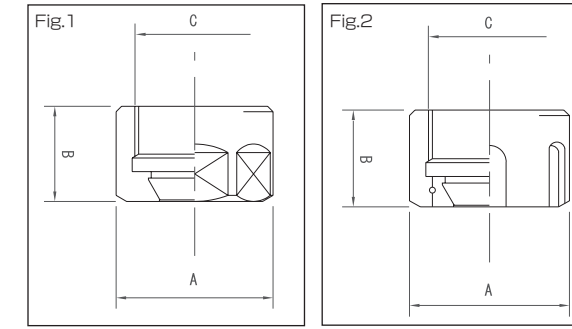

	コード Code	図 Fig.	φ A	B	C	適用スパナ Applicable spanner
標準クラмпिंग ナット・スパナ Standard clamping nut/spanner	Hi-Q/ER 11	1	19	11.3	M14 × 0.75	GS17
			28	17.5	M22 × 1.5	GS25
	Hi-Q/ER 20	2	34	19	M25 × 1.5	GS30
			42	20	M32 × 1.5	E25
			50	22.5	M40 × 1.5	E32
フリクションベアリング ナット・スパナ Friction bearing nut/spanner	Hi-Q/ERB16	1	28	20.2	M22 × 1.5	GS25
			34	21.7	M25 × 1.5	GS30
	Hi-Q/ERB25	2	42	22.6	M32 × 1.5	E25
			50	25	M40 × 1.5	E32

#### MSe用 KERコレット KER Collet for MSe

φ D チャッキング径 Chucking diameter	MSe11				MSe16				MSe20			
	最小 Min.	最大 Max.	普通級 Normal class	高精度級 High-precision class	最小 Min.	最大 Max.	普通級 Normal class	高精度級 High-precision class	最小 Min.	最大 Max.	普通級 Normal class	高精度級 High-precision class
0.5	1	KER-11 × 1	KER-U-11 × 1	0.5	1	KER-16 × 1	KER-U-16 × 1	2	3	KER-20 × 3	KER-U-20 × 3	
1	1.5	KER-11 × 1.5	KER-U-11 × 1.5	1	1.5	KER-16 × 1.5	KER-U-16 × 1.5	2.5	3.5	KER-20 × 3.5	KER-U-20 × 3.5	
1.5	2	KER-11 × 2	KER-U-11 × 2	1	2	KER-16 × 2	KER-U-16 × 2	3	4	KER-20 × 4	KER-U-20 × 4	
2	2.5	KER-11 × 2.5	KER-U-11 × 2.5	1.5	2.5	KER-16 × 2.5	KER-U-16 × 2.5	3.5	4.5	KER-20 × 4.5	KER-U-20 × 4.5	
2.5	3	KER-11 × 3	KER-U-11 × 3	2	3	KER-16 × 3	KER-U-16 × 3	4	5	KER-20 × 5	KER-U-20 × 5	
3	3.5	KER-11 × 3.5	KER-U-11 × 3.5	2.5	3.5	KER-16 × 3.5	KER-U-16 × 3.5	4.5	5.5	KER-20 × 5.5	KER-U-20 × 5.5	
3.5	4	KER-11 × 4	KER-U-11 × 4	3	4	KER-16 × 4	KER-U-16 × 4	5	6	KER-20 × 6	KER-U-20 × 6	
4	4.5	KER-11 × 4.5	KER-U-11 × 4.5	3.5	4.5	KER-16 × 4.5	KER-U-16 × 4.5	5.5	6.5	KER-20 × 6.5	KER-U-20 × 6.5	
4.5	5	KER-11 × 5	KER-U-11 × 5	4	5	KER-16 × 5	KER-U-16 × 5	6	7	KER-20 × 7	KER-U-20 × 7	
5	5.5	KER-11 × 5.5	KER-U-11 × 5.5	4.5	5.5	KER-16 × 5.5	KER-U-16 × 5.5	6.5	7.5	KER-20 × 7.5	KER-U-20 × 7.5	
5.5	6	KER-11 × 6	KER-U-11 × 6	5	6	KER-16 × 6	KER-U-16 × 6	7	8	KER-20 × 8	KER-U-20 × 8	
6	6.5	KER-11 × 6.5	KER-U-11 × 6.5	5.5	6.5	KER-16 × 6.5	KER-U-16 × 6.5	7.5	8.5	KER-20 × 8.5	KER-U-20 × 8.5	
6.5	7	KER-11 × 7	KER-U-11 × 7	6	7	KER-16 × 7	KER-U-16 × 7	8	9	KER-20 × 9	KER-U-20 × 9	
				6.5	7.5	KER-16 × 7.5	KER-U-16 × 7.5	8.5	9.5	KER-20 × 9.5	KER-U-20 × 9.5	
				7	8	KER-16 × 8	KER-U-16 × 8	9	10	KER-20 × 10	KER-U-20 × 10	
				7.5	8.5	KER-16 × 8.5	KER-U-16 × 8.5	9.5	10.5	KER-20 × 10.5	KER-U-20 × 10.5	
				8	9	KER-16 × 9	KER-U-16 × 9	10	11	KER-20 × 11	KER-U-20 × 11	
				8.5	9.5	KER-16 × 9.5	KER-U-16 × 9.5	10.5	11.5	KER-20 × 11.5	KER-U-20 × 11.5	
				9	10	KER-16 × 10	KER-U-16 × 10	11	12	KER-20 × 12	KER-U-20 × 12	
				9.5	10.5	KER-16 × 10.5	KER-U-16 × 10.5	11.5	12.5	KER-20 × 12.5	KER-U-20 × 12.5	
				10	11	KER-16 × 11	KER-U-16 × 11	12	13	KER-20 × 13	KER-U-20 × 13	

φ D チャッキング径 Chucking diameter	MSe25				MSe32			
	最小 Min.	最大 Max.	普通級 Normal class	高精度級 High-precision class	最小 Min.	最大 Max.	普通級 Normal class	高精度級 High-precision class
2	3	KER-25 × 3	KER-U-25 × 3	5	6	KER-32 × 6	KER-U-32 × 6	
2.5	3.5	KER-25 × 3.5	KER-U-25 × 3.5	5.5	6.5	KER-32 × 6.5	KER-U-32 × 6.5	
3	4	KER-25 × 4	KER-U-25 × 4	6	7	KER-32 × 7	KER-U-32 × 7	
3.5	4.5	KER-25 × 4.5	KER-U-25 × 4.5	6.5	7.5	KER-32 × 7.5	KER-U-32 × 7.5	
4	5	KER-25 × 5	KER-U-25 × 5	7	8	KER-32 × 8	KER-U-32 × 8	
4.5	5.5	KER-25 × 5.5	KER-U-25 × 5.5	7.5	8.5	KER-32 × 8.5	KER-U-32 × 8.5	
5	6	KER-25 × 6	KER-U-25 × 6	8	9	KER-32 × 9	KER-U-32 × 9	
5.5	6.5	KER-25 × 6.5	KER-U-25 × 6.5	8.5	9.5	KER-32 × 9.5	KER-U-32 × 9.5	
6	7	KER-25 × 7	KER-U-25 × 7	9	10	KER-32 × 10	KER-U-32 × 10	
6.5	7.5	KER-25 × 7.5	KER-U-25 × 7.5	9.5	10.5	KER-32 × 10.5	KER-U-32 × 10.5	
7	8	KER-25 × 8	KER-U-25 × 8	10	11	KER-32 × 11	KER-U-32 × 11	
7.5	8.5	KER-25 × 8.5	KER-U-25 × 8.5	10.5	11.5	KER-32 × 11.5	KER-U-32 × 11.5	
8	9	KER-25 × 9	KER-U-25 × 9	11	12	KER-32 × 12	KER-U-32 × 12	
8.5	9.5	KER-25 × 9.5	KER-U-25 × 9.5	11.5	12.5	KER-32 × 12.5	KER-U-32 × 12.5	
9	10	KER-25 × 10	KER-U-25 × 10	12	13	KER-32 × 13	KER-U-32 × 13	
9.5	10.5	KER-25 × 10.5	KER-U-25 × 10.5	12.5	13.5	KER-32 × 13.5	KER-U-32 × 13.5	
10	11	KER-25 × 11	KER-U-25 × 11	13	14	KER-32 × 14	KER-U-32 × 14	
10.5	11.5	KER-25 × 11.5	KER-U-25 × 11.5	13.5	14.5	KER-32 × 14.5	KER-U-32 × 14.5	
11	12	KER-25 × 12	KER-U-25 × 12	14	15	KER-32 × 15	KER-U-32 × 15	
11.5	12.5	KER-25 × 12.5	KER-U-25 × 12.5	14.5	15.5	KER-32 × 15.5	KER-U-32 × 15.5	
12	13	KER-25 × 13	KER-U-25 × 13	15	16	KER-32 × 16	KER-U-32 × 16	
12.5	13.5	KER-25 × 13.5	KER-U-25 × 13.5	15.5	16.5	KER-32 × 16.5	KER-U-32 × 16.5	
13	14	KER-25 × 14	KER-U-25 × 14	16	17	KER-32 × 17	KER-U-32 × 17	
13.5	14.5	KER-25 × 14.5	KER-U-25 × 14.5	16.5	17.5	KER-32 × 17.5	KER-U-32 × 17.5	
14	15	KER-25 × 15	KER-U-25 × 15	17	18	KER-32 × 18	KER-U-32 × 18	
14.5	15.5	KER-25 × 15.5	KER-U-25 × 15.5	17.5	18.5	KER-32 × 18.5	KER-U-32 × 18.5	
15	16	KER-25 × 16	KER-U-25 × 16	18	19	KER-32 × 19	KER-U-32 × 19	
				18.5	19.5	KER-32 × 19.5	KER-U-32 × 19.5	
				19	20	KER-32 × 20	KER-U-32 × 20	

